

UCI  
CROSS COUNTRY  
WORLD CUP

UCI  
SHORT TRACK  
WORLD CUP

UCI  
DOWNHILL  
WORLD CUP

UCI  
ENDURO  
WORLD CUP

# TEAMS GUIDE



05. - 08. JUNE 2025

WHOOP

UCI  
MOUNTAIN BIKE  
WORLD SERIES



SAALFELDEN LEOGANG  
SALZBURGERLAND  
IN ÖSTERREICH'S GRÖSSTER BIKE-REGION

© moritz-ablanger.com



► PATRON ST 900 TUNED

# OVER AND ABOVE

Modernste Technologie trifft auf unvergleichliches Design: Mit dem neuen Patron eRIDE bist du bereit für alles – von smoothen Trails bis hin zu anspruchsvollem Gelände.



## COMPETITION PROGRAM



Den aktuellen Zeitplan findest du online: [mtb-weltcup.at](https://mtb-weltcup.at)

The current schedule can be found online: [mtb-weltcup.at](https://mtb-weltcup.at)



UCI  
CROSS COUNTRY  
WORLD CUP



WHOOP AWS MICHELIN SHIMANO events.com MOTUL HARLEY KIRCHER VULCAN RSC G SCOTT INNS UCIWORLDSPORTS.COM UCIWORLDSPORTS.COM UCIWORLDSPORTS.COM UCIWORLDSPORTS.COM

SAALFELDEN LEO GANG  
SALZBURGERLAND  
CROSS-COUNTRY  
OLYMPIC

REGULAR LAP

Length: 3.6km Elevation Ascent: 168m

Regular Lap



Start/Finish

UCI  
SHORT TRACK  
WORLD CUP



WHOOP AWS MICHELIN SHIMANO events.com MOTUL HARLEY KIRCHER VULCAN RSC G SCOTT INNS UCIWORLDSPORTS.COM UCIWORLDSPORTS.COM UCIWORLDSPORTS.COM UCIWORLDSPORTS.COM

SAALFELDEN LEO GANG  
SALZBURGERLAND  
CROSS-COUNTRY  
SHORT TRACK

COURSE

Length: 1.2km Elevation Ascent: 53m

Regular Lap



Start/Finish

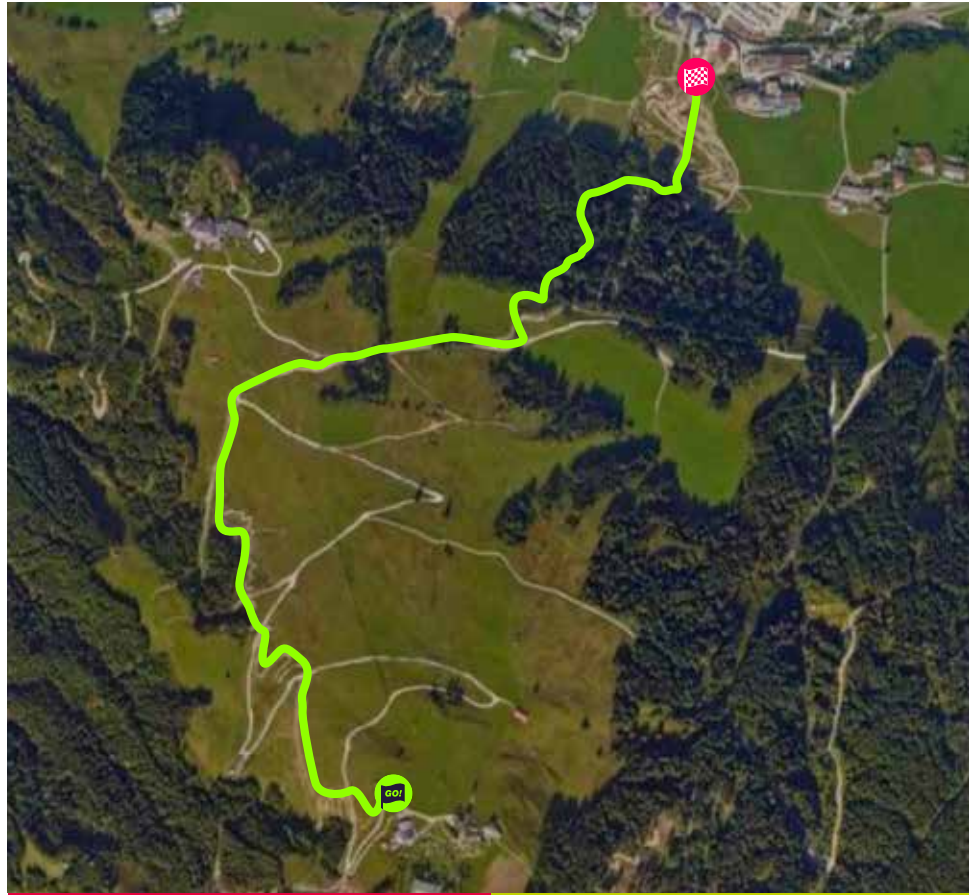

<b>COURSE LENGTH</b>	2.1km
<b>ELEVATION</b>	-462m

Course	Start	Finish
<div></div>	<div></div>	<div></div>

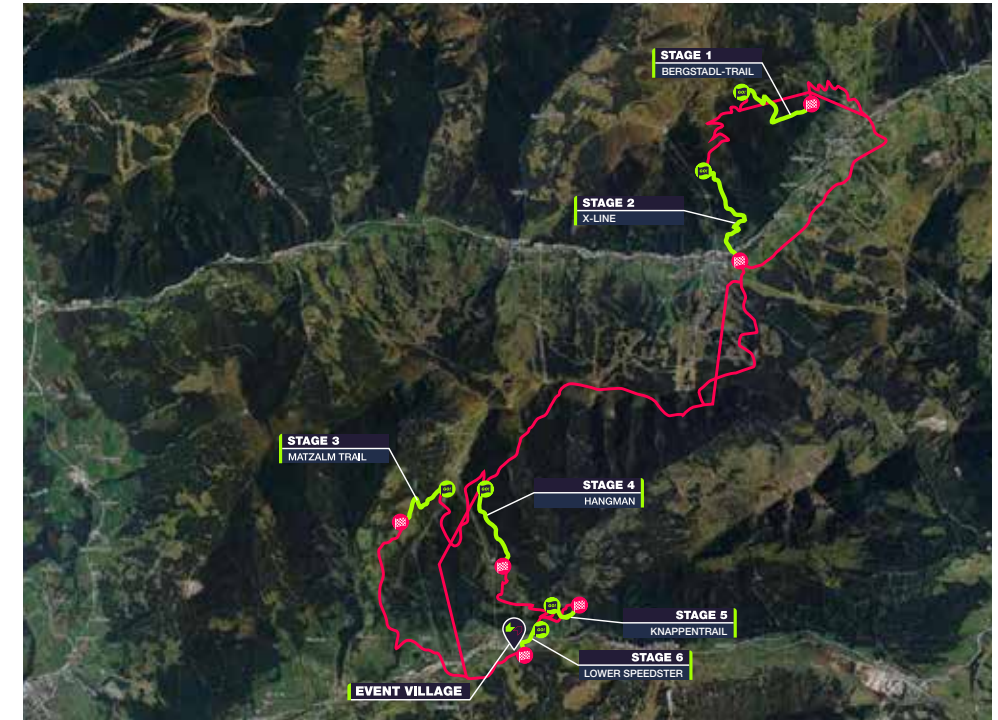

Length: 66.79km

Length: 2.56km Elevation: -480m

Length: 3.6km    Elevation: -680m

Length: 1.43km Elevation: -280m

Length: 2.04km Elevation: -320m



Length: 1.01km Elevation: -140m

Length: 0.68km Elevation: -160m



# INFORMATION

## MEDICAL

A fully dedicated Medical team will be in attendance during all official practice and competition times. The Medical team will consist of a Doctor, Paramedics and First Responders. These resources will be strategically located on course as well as at the Medical marquee located in the venue.

## ANTI-DOPING

The Anti-Doping facility will be located only a short walk away from the finish line. See overview venue. Riders identified for testing are asked to walk with their chaperone and team manager to the Anti-Doping Venue.

## WEB & SOCIAL MEDIA

Check out our online BIKE CHANNEL on: [mtb-weltcup.at](http://mtb-weltcup.at)  
For event updates:



[facebook.com/BikeparkLeogang](https://facebook.com/BikeparkLeogang)  
[facebook.com/SaalfeldenLeogang](https://facebook.com/SaalfeldenLeogang)



[instagram.com/bikeparkleogang](https://instagram.com/bikeparkleogang)  
[instagram.com/saalfelden\\_leogang](https://instagram.com/saalfelden_leogang)

## AWARD CEREMONIES

Award ceremonies will take place at the finish area. Towels and sealed drinking water will be provided for athletes. Due to limited space only one support staff member will be permitted into this area to assist preparing the athlete for award ceremonies.

## CAMPING

A reservation for the camping area is required! The camping area is located at the parking space of the Steinberg lift. It is only a 10-minutes walk from the event area.



**WHOOP UCI  
MTB WORLD  
SERIES WEBSITE**

Find all the infos on the  
official World Cup Website  
[mtb-weltcup.at](http://mtb-weltcup.at)



#MTBWORLDCUP #saalfeldenleogang #bikeparkleogang

# NATIONAL FEDERATION & TEAM AREA

The ground surface of the area is gravel or tar-mac. All Marquees must be suitably weighted.

A dedicated bike wash area will be on-site. It's not permitted to wash bikes at the team area.

Overnight security is provided at the venue by the organiser. The security team will be roaming the team/tech village.

## TEAM OFFICE

The Team Area Office (Container) will be located at the entrance of the Area (bridge). Teams can visit the Team Area Office for any issues. The Office will be manned at the arrival & set up and opening times.

Contact Team Area: Ms. Sarah Windisch  
[event@leoganger-bergbahnen.at](mailto:event@leoganger-bergbahnen.at) / +43 676 88219217  
(reachable by phone 08.00 am - 08.00 pm)

Keep our event area and the Epic Bikepark Leogang area clean! General waste containers are located throughout the venue. Please ensure that your team space is kept clean and free of rubbish.

Nevertheless, please lock away everything important, especially over night! Also keep in mind that your car is not a safe place to store your bike!

**WLAN @TEAM AREA:**  
Name: TEAM AREA  
PW: Teams@leogang2025

## ARRIVAL & SET UP TIMES

Tuesday, 03 <sup>th</sup> June	12.00 am-06.00 pm
Wednesday, 04 <sup>th</sup> June	08.00 am-08.00 pm

## OPENING HOURS TEAM & EXPO AREA:

Friday, 06 <sup>th</sup> June	09.00 am-07.00 pm
Saturday, 07 <sup>th</sup> June.	09.00 am-07.00 pm
Sunday, 08 <sup>th</sup> June	09.00 am-05.00 pm



# ACCREDITATION & RIDERS CONFIRMATION

**LOCATION** Hotel Salzburger Hof, Sonnberg 170, 5771 Leogang  
**Please use backside entry.**

**PLEASE NOTE THAT...**

**XCC/XCO** riders/team have **no lift access included**.

**DHI** riders may use **FRONT ACCESS** only on Wednesday (for track walk) and the **BACK ACCESS** from Thursday to Saturday (access with race kit, wristband & bike number plate) DHI team members also require an access wristband.

**EDR** riders use **ONLY** the Steinbergbahn from Friday to Sunday (lift ticket required).

Team managers (all disciplines must collect the access authorizations for all team riders at accreditation.

All individuals – including athletes and team managers (except media) – need an access wristband to enter the venue. The season pass or swing tags (e.g. AAA, Sport) only indicate extended access rights but do not replace the wristband.

**OPENING HOURS ACCREDITATION**

Wednesday, 04<sup>th</sup> June 08.30 a.m. - 05.00 p.m.  
Thursday, 05<sup>th</sup> June 08.00 a.m. - 05.00 p.m.  
Friday, 06<sup>th</sup> June 08.00 a.m. - 12.00 p.m.

On Saturday, 07<sup>th</sup> June and Sunday, 08<sup>th</sup> June please contact the info center of the mountain railways (next to ticket offices, open from 08:00 to 16:30) and only in urgent cases the accreditation hotline +43 6583 8219 256.

**OPENING HOURS RIDERS CONFIRMATION**

Wednesday, 04<sup>th</sup> June  
Riders Confirmation DHI:

08.30 - 10.00 a.m. - UCI MTB WS Teams  
10.00 - 12.00 p.m. - All Riders  
02.30 - 05.00 p.m. - Final Confirmation

Riders Confirmation XCO/XCC + EDR:

12.30 - 01.30 p.m. - UCI MTB WS Teams  
02.30 - 05.00 p.m. - All Riders

Thursday, 05<sup>th</sup> and Friday, 06<sup>th</sup> June  
Riders Confirmation XCO/XCC + EDR:

08:00 - 10:00 a.m. - All Riders

## OVERVIEW VENUE

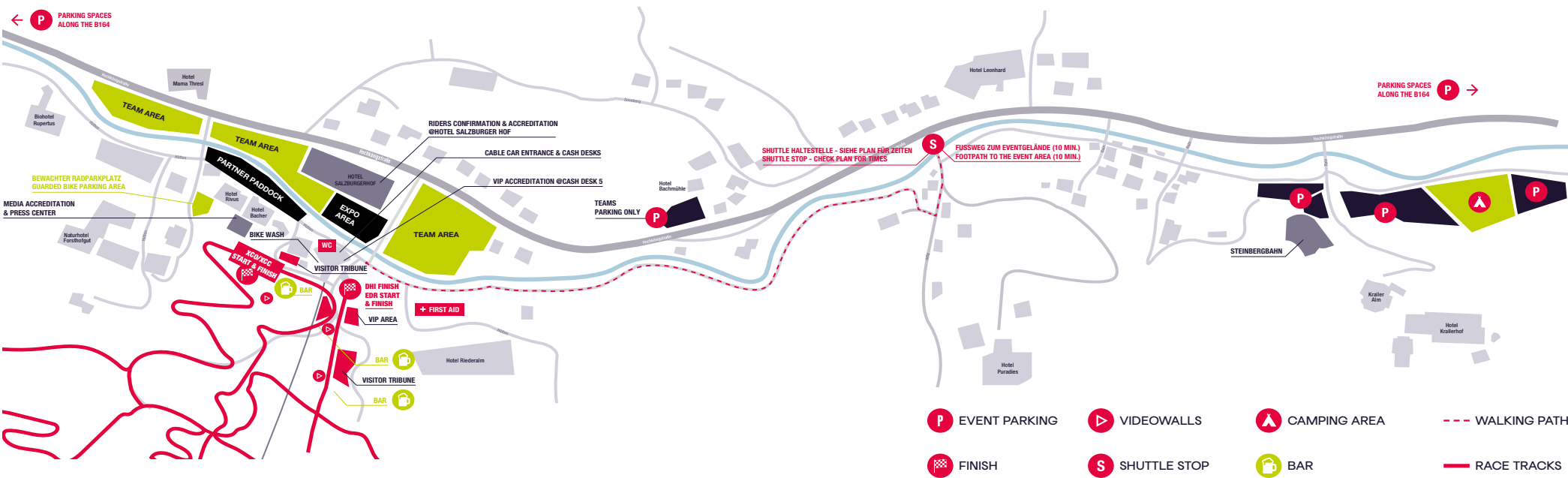



## TRANSPORT – TAXIS

Bernis Taxi	Saalfelden	+43 (0) 6582 75237
Bernis Taxi	Leogang	+43 (0) 6583 93030
Taxi Bachmaier	Saalfelden	+43 (0) 6582 71732
Taxi Pfeiffer	Saalfelden	+43 (0) 6582 2010
Taxi Hörl	Leogang	+43 (0) 6583 85420
Taxi Stöckl	Leogang	+43 (0) 6583 7579
Mein Taxi	Saalfelden	+43 (0) 6582 20727
Taxidienst Pliem	Saalfelden	+43 (0) 6582 72444
Funktaxi	Saalfelden	+43 (0) 6582 76000

## HOTELS & RESTAURANTS - LEOGANG

Wellnesshotel Krallerhof / Kralleralm	Rain 6	+43 (0) 6583 82460
Hotel Forsthofgut	Hütten 2	+43 (0) 6583 8561
Hotel Der Löwe	Dorf 119	+43 (0) 6583 7428
Hotel Leonhard	Sonnberg 140	+43 (0) 6583 8542
Hotel Restaurant Riederalm	Rain 100	+43 (0) 6583 7342
Hotel Rupertus	Hütten 40	+43 (0) 6583 8466
Hotel Bacher Asitzstüb'n	Hütten 33	+43 (0) 6583 8556
Hotel Kirchenwirt	Leogang Nr. 3	+43 (0) 6583 8216
Sport Herzog Pizzeria	Dorf 126	+43 (0) 6583 7287
Hotel mama thresl	Sonnberg 252	+43 (0) 6583 20800
Puradies	Rain 9	+43 (0) 6583 8275
Pizzeria Damals	Leogang 41	+43 (0) 6583 20412
Dorfalm Leogang	Sonnrain 30/31	+43 (0) 6583 8509
Cafe Restaurant Birnhorn	Sonnrain 62	+43 (0) 664 886 742 77
Hüttwirt	Hütten 9	+43 (0) 6583 8227
LEOs Kitchen & Bar	Leogang 62	+43 (0) 6583 742862
Loigoma Bistro	Rain 130	+43 (0) 660 5775771

## HOTELS & RESTAURANTS - SAALFELDEN

Hotel Restaurant Ritzenhof	Ritzenseestr. 33	+43 (0) 6582 73806
Vitalhotel Saliterhof	Uttenhofen 5	+43 (0) 6582 73381
Hotel Die Hindenburg	Bahnhofstrasse 6	+43 (0) 6582 793
Pizzeria LaPiazza	Rathausplatz 2	+43 (0) 6582 76257
Restaurant zum Griechen	Mittergasse 15	+43 (0) 6582 71516

## EMERGENCY CALL

European emergency number:	112
Mountain rescue:	140
Rescue services:	144

## PHYSIOTHERAPY

Physio Drehpunkt  
Leogang 62 / 5771 Leogang  
Phone: +43 (0) 6583 20104  
office@physiotherapie-drehpunkt.at

## CONTACT

Saalfelden Leogang Event GmbH  
Mittergasse 21a / 5760 Saalfelden  
+43 (0) 6582 70660 / info@saalfelden-leogang.at

/// / Fotos: EXPA Pictures © JFK, KLAUS BAUER, Moritz Ablinger, Stefan Voitl



# ÖSTERREICH'S GRÖSSTE BIKE-REGION!

über 105 km Lines & Trails - 9 Bergbahnen - 7 Berge

[bike.saalbach.com](http://bike.saalbach.com)



**bike festival**  
Saalfelden Leogang

12.09. - 14.09.25

# ALL ABOUT BIKES

[bike-festival.de](http://bike-festival.de)

**RIDE WITH THE PROS  
WORKSHOPS  
KIDS CUP  
PUMPTRACK  
TESTEN  
EXPO**

EIN EVENT VON DELIUS KLASING & BIKE MAGAZIN

Host



**THE EPIC  
BIKE PARK  
LEOGANG**

Main Sponsor



**SCOTT**

APOTHEKEN  
**Umschau**

**medizini**

Co Sponsor

